





Capicorda a compressione meccanica CU, DIN 46234, 70 - 95mm²

Tipo Q, per conduttori in rame

<p>Codice articolo: Q95-16</p> <p>Imballo: 25</p>	
<div>    </div>	

CARATTERISTICHE TECNICHE

Materiale:	Rame ETP (CW004A)
Superficie:	Stagnato elettroliticamente
Sezione cavo (mm ²):	70 - 95
Bullone (Ø):	16
Produttore:	Gruppo Cembre

DIMENSIONI

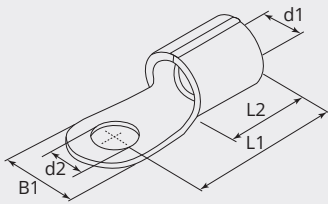

DIMENSIONI

L1 (mm):	70.0
L2 (mm):	20.0
B1 (mm):	28.0
d1 (Ø):	15.0
d2 (Ø):	17.0