





# Capicorda a compressione meccanica CU, DIN 46234, 70 - 95mm<sup>2</sup>

Tipo Q, per conduttori in rame

<p>Codice articolo: Q95-10</p> <p>Imballo: 25</p>	
<div>    </div>	

## CARATTERISTICHE TECNICHE

Materiale:	Rame ETP (CW004A)
Superficie:	Stagnato elettroliticamente
Sezione cavo (mm <sup>2</sup> ):	70 - 95
Bullone (Ø):	10
Produttore:	Gruppo Cembre

## DIMENSIONI

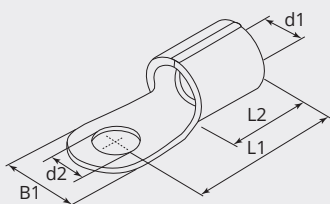

## DIMENSIONI

L1 (mm):	42.0
L2 (mm):	20.0
B1 (mm):	24.0
d1 (Ø):	15.0
d2 (Ø):	10.5