



# Capicorda a compressione meccanica CU, DIN 46234, 25 - 35mm<sup>2</sup>

Tipo Q, per conduttori in rame

<p>Codice articolo: Q35-8</p> <p>Imballo: 100</p>	
<div> <div>CE</div> <div>  </div> <div>  </div> </div>	

## CARATTERISTICHE TECNICHE

Materiale:	Rame ETP (CW004A)
Superficie:	Stagnato elettroliticamente
Sezione cavo (mm <sup>2</sup> ):	25 - 35
Bullone (Ø):	8
Produttore:	Gruppo Cembre

## DIMENSIONI

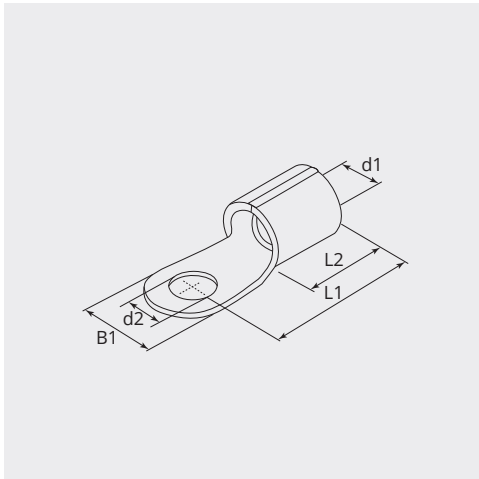

## DIMENSIONI

L1 (mm):	26.0
L2 (mm):	12.0
B1 (mm):	16.0
d1 (Ø):	9.0
d2 (Ø):	8.4