

Holder for insert bits, hexagonal 7/8"

1 inch drive

Item number: MO-H9-7/8
 Product weight (kg): 0.7 kg
 Packing unit: 1



TECHNICAL CHARACTERISTICS

| | |
|---------------|-------------|
| Drive: | 1 |
| Material: | steel |
| Surface: | Silverline™ |
| Manufacturer: | Momento AS |

DIMENSIONS

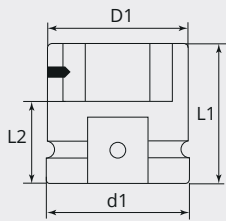

DIMENSIONS

| | |
|----------|------|
| L1 (mm): | 60.0 |
| L2 (mm): | 40.0 |
| D1 (Ø): | 48 |
| D2 (Ø): | 54 |

The insert bit is secured by means of a hexagon socket screw with pointed end in a V-shaped groove.
If necessary, the screw can be further secured by Loctite (screw lock).