

# C-Sleeve CU, tin plated

Type C-CST

<p>Item number: C150-C120ST</p> <p>Packing unit: 25</p>	
<p>CE</p> <p>RoHS</p>	

## TECHNICAL CHARACTERISTICS

Main conductor (mm <sup>2</sup> ):	150 - 160
Branch conductor (mm <sup>2</sup> ):	25 - 125
Material:	ETP copper (CW004A)
Surface:	tin plated

## DIMENSIONS

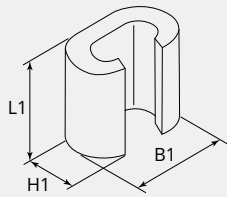

## DIMENSIONS

L1 (mm):	31.0
B1 (mm):	45.0
Height (mm):	28

## Note

Each C-sleeve is marked as follows: Company logo, type, cross-section main conductor (mm<sup>2</sup>), cross-section branch conductor (mm<sup>2</sup>), number of crimps, and code of dies.